

BLACK MASK PRINTING  
REFER TO: RAL9005

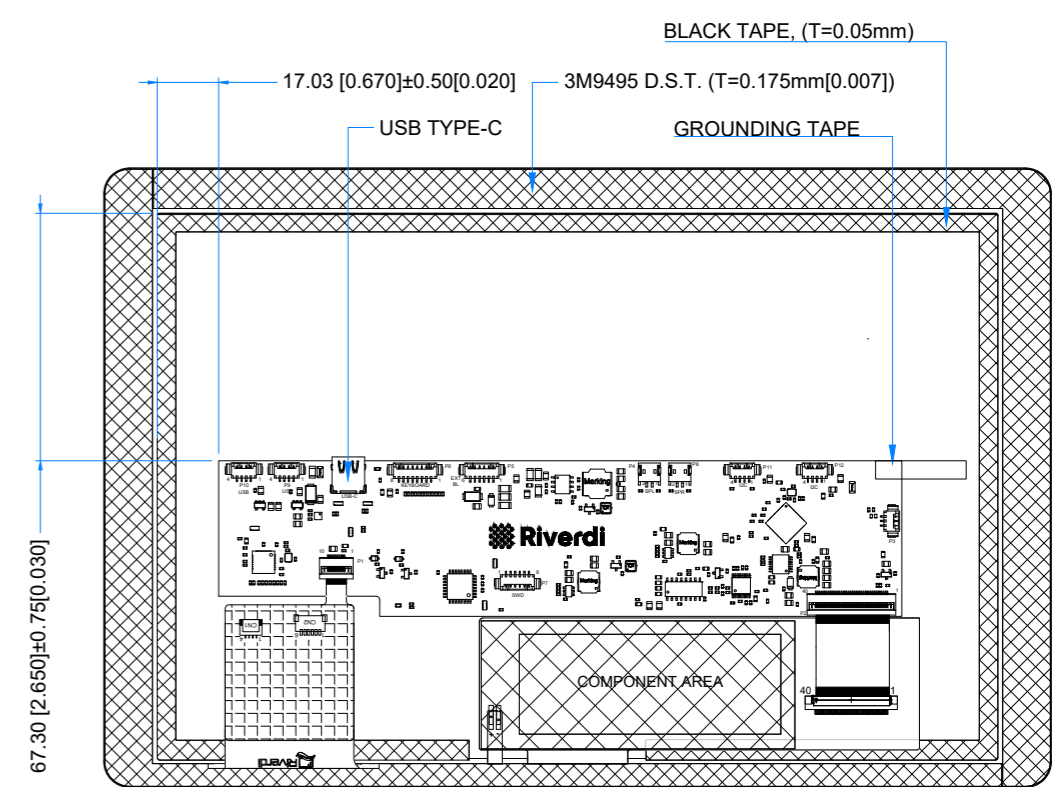
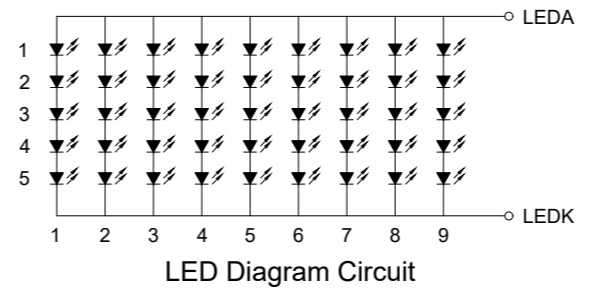
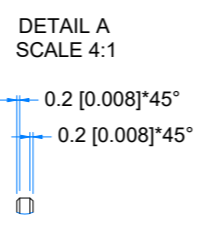
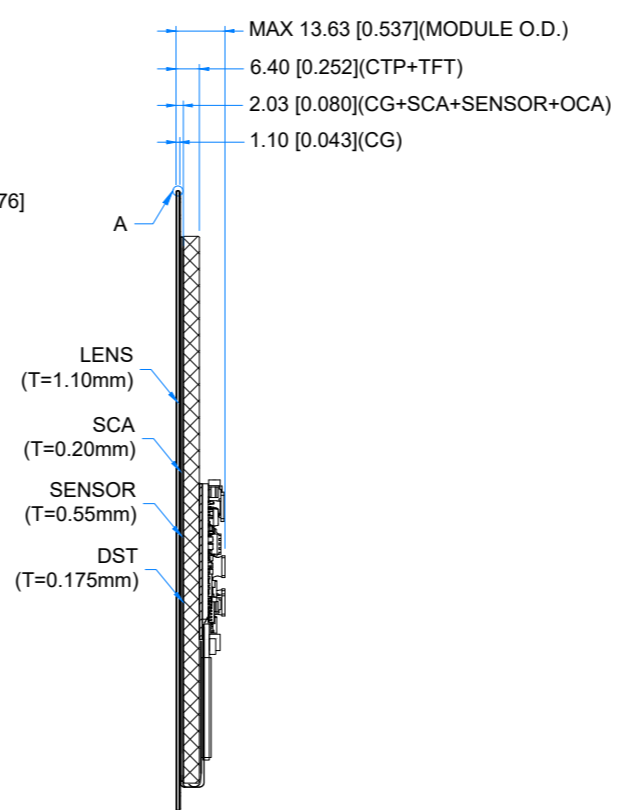

PINOUT ON THE 2ND PAGE

**LCD NOTES:**  
 1. LCD TYPE: TRANSMISSIVE, NORMALLY BLACK, IPS  
 2. RESOLUTION: 1280x800  
 3. VIEWING ANGLE: FREE  
 4. CONTROLLER IC OF MAIN BOARD: LT7911D  
 5. VIDEO INTERFACE: USB-C

**TP NOTES:**  
 1. TP STRUCTURE: G+G  
 2. CG THICKNESS: 1.10mm[0.043inch]  
 3. SURFACE HARDNESS: 7H  
 4. DRIVER IC: ILI2132A  
 5. INTERFACE: USB-C

**GENERAL NOTES:**  
 1. MODULE SURFACE LUMINANCE: 850 cd/m<sup>2</sup>  
 2. OPERATING TEMPERATURE: -20°C ~ 70°C  
 3. STORAGE TEMPERATURE: -30°C ~ 80°C  
 4. WITHOUT INDIVIDUAL TOLERANCE: ±0.3mm[0.012inch]  
 5. USB-C Power supply 5.0V  
 6. RoHS3 COMPLIANT

PN: RVT101HVUNWC00-B V2			
SN:			
DRAWN: M.Stabinski	2026.04.29	1:2.06	
CHECKED: K.Szymanski	2026.04.29	[mm]	
APPR: M.Wierzbowski	2026.04.29	ISO A3	



EXTERNAL KEYBOARD CONNECTOR - P6			
Pin No.	Desc.	Pin No.	Desc.
1	DOWN	2	UP
3	EXIT	4	MENU
5	PWR	6	LED_EN
7	GND	8	KEYBOARD VDD

BACKLIGHT PWM & POWER - P5			
Pin No.	Desc.	Pin No.	Desc.
1	GND	2	GND
3	EN	4	PWM
5	VDD	6	VDD